



IsoFlex Technologies Pty Ltd.

Unit 33, 75 Waterway Drive, Gold Coast Marine Precinct, Coomera, Queensland, Australia. 4209
 Ph: 1300 366 393 Ph: 07 555 60 924 F: 07 555 60 984 Int prefix: 617
 Email: info@isoflex.com.au
 Home Page: www.isoflex.com.au

IsoFlex Mount Data Sheet

Loading:

1. Axial - Vertical Down (A-direction)

Mount Model: GPM10-12B

Mount Model: GPM10-1/2"B

Mount Model: GPM10-16B

'GPM10' = model number
 '12, 1/2", 16 ' = thread size
 'B' = bolt type

Resilient Element Colour	Shore Durometer Hardness A-scale SDH-A
Yellow	50
Red	60
Black	70
Royal Blue	75

Base: Black - 75 SDH-D

LOAD
Lbs kg

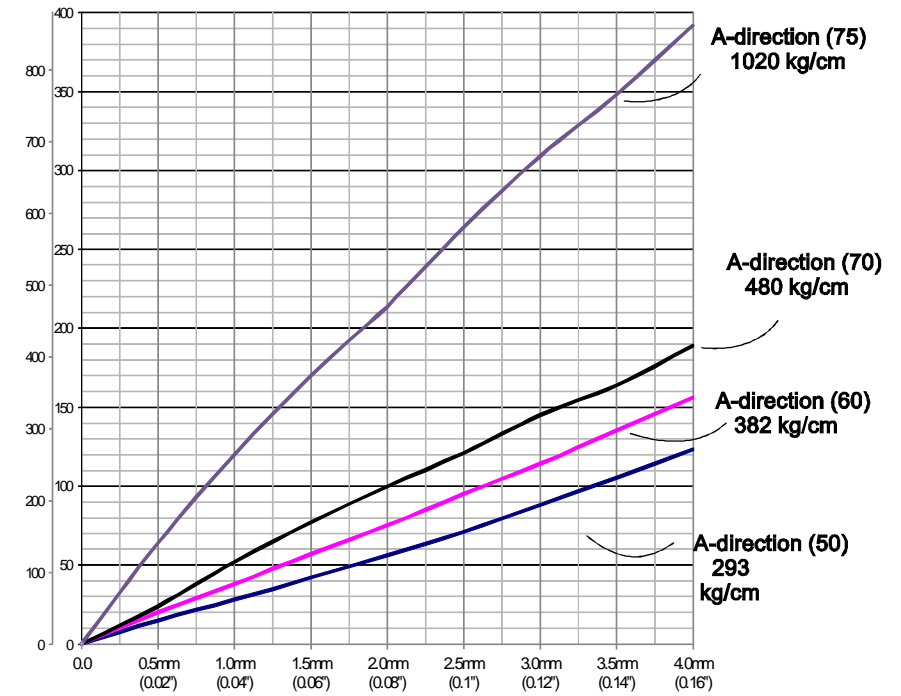

All metal components zinc plated to ASTM B633 SC3

Graph:

1. Static Axial Vertical Load[kg] (A-direction) versus Deflection[mm] (ins)

Note: Stated Spring Rate average @ 3mm

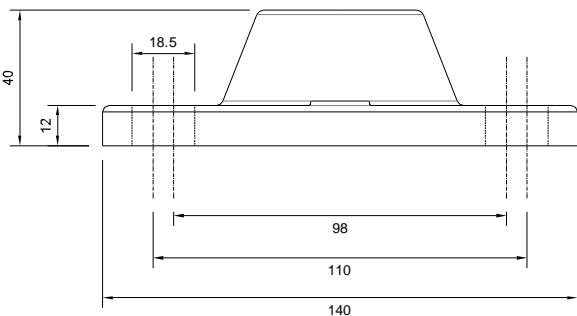
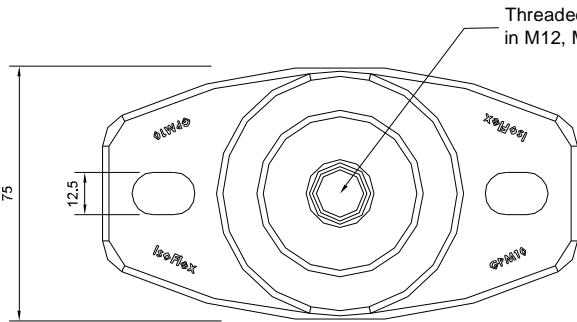

GPM10 General Arrangement

Important: Do not point load Steel Threaded Insert. Use large outside dia washer or base of equipment to ensure load is applied across top flat section mount.

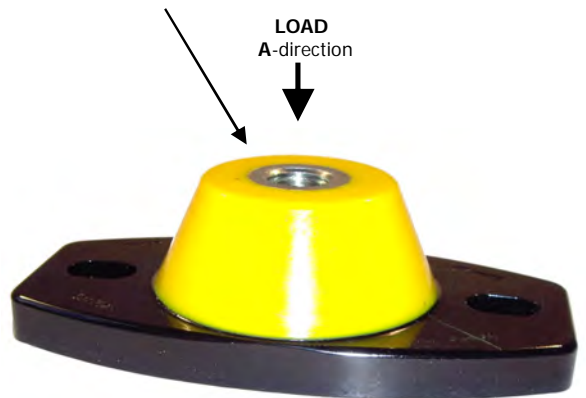

Dimensions in millimetres (mm.) - unless stated otherwise

Drawing Number: DSA-GPM10 Rev2
 Drawn: WF Date: 25 Nov 2011

Copyright © 2011 **IsoFlex Technologies Pty Ltd.**

Specifications are subject to change without notice.