

Item 1: High Tensile Engineering Polymer Disc - Red (90 SDH A)

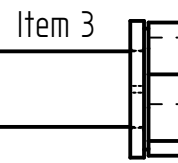
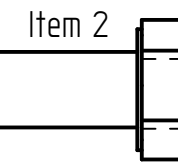
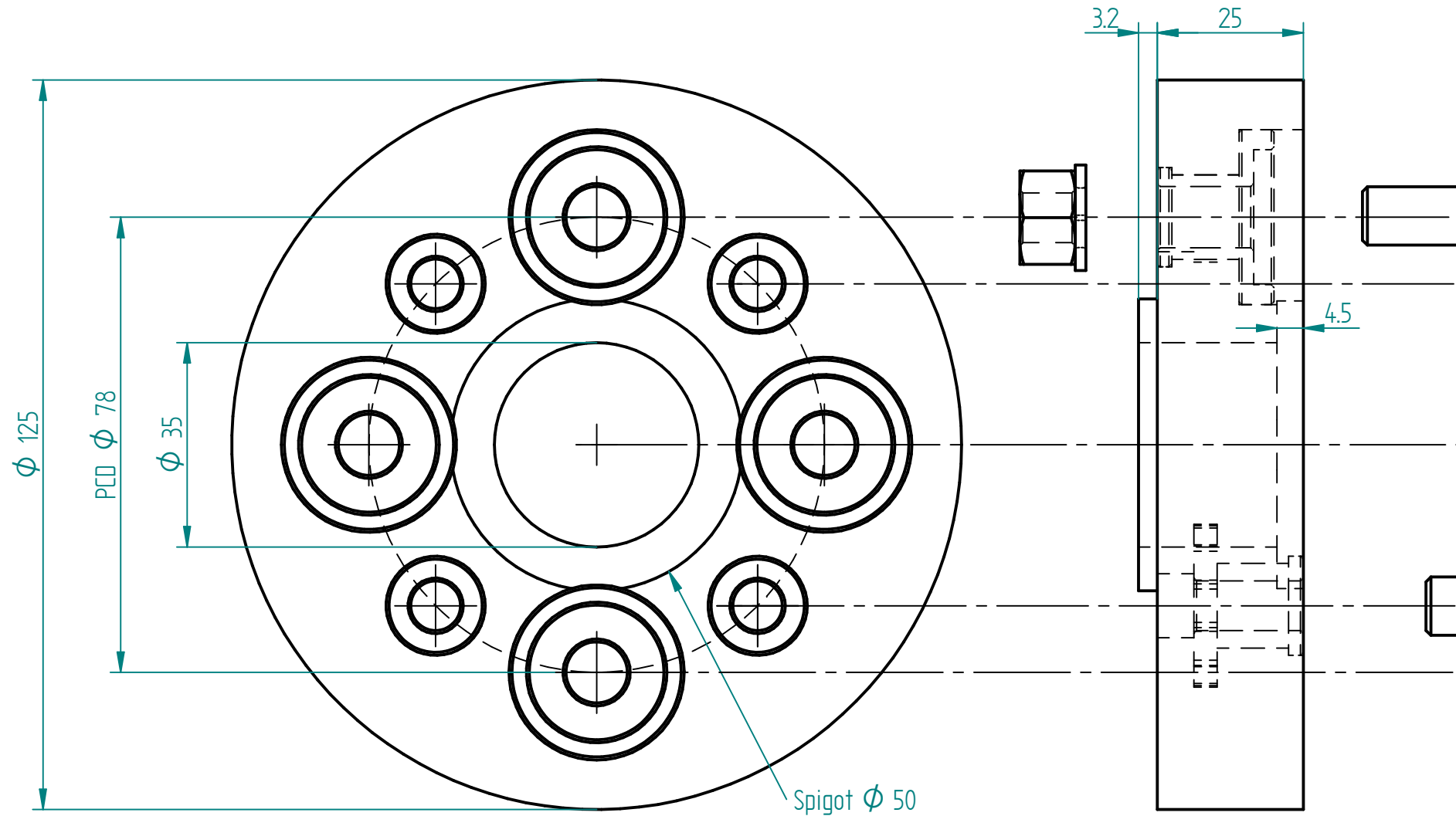

IFC-4200 Coupling Rating:
 -Pleasure Craft 680 Nm
 -Intermediate 600 Nm
 -Continuous 400 Nm

M10 Hex Bolt - AS1110 Prop. CL. Grade / AS2465 Grade 8 Zinc Plated

Bolt Shear Capacity 'Thread' = 26 kN
 Bolt Pattern Shear Capacity = 4056 Nm
 Bolt Pattern Design Torque = 1014 Nm

Bolt Pattern Design Torque = $\frac{1}{4}$ x Bolt Pattern Shear Capacity [Nm]

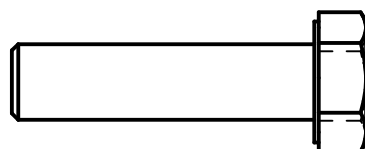
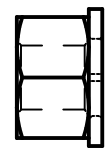

Item 2: M10 x 40 Hex Head Bolt, Nut & Spring Washer
 Qty: 4

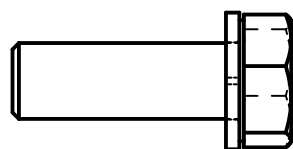

Item 3: M10 x 30 Hex Head Setscrew & Spring Washer
 Qty: 4

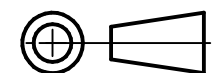

Copyright © 2019 Isoflex Technologies PTY Ltd				
TITLE		IFC-4200 General Arrangement		
	NAME	DATE		
DRAWN	Matthew McCart	19/Aug/19		
CHECKED	Cam Ewart	19/Aug/19		
APPR	Matthew McCart	19/Aug/19		
UNLESS OTHERWISE SPECIFIED DIMENSIONS ARE IN MILLIMETERS		SIZE	DWG NO	REV
		A3	IFC-4200-GA	R2
DRAWING NOT TO SCALE SPECIFICATIONS SUBJECT TO CHANGE WITHOUT NOTICE		FILE NAME: IFC-4200-GA-R2.dft		
SCALE:		WEIGHT:		SHEET 1 OF 1

