

1/2" UNC SHCS - AS2465 Grade 8 Zinc Plated

Bolt Shear Capacity 'Thread' [BSC] = 52kN
 Bolt Pattern Shear Capacity [BPSC] = 18,720 Nm
 Bolt Pattern Design Torque [BPDT] = 6,240 Nm

$BDPT = \frac{1}{3} \times BPSC$

IFC-6125-95 Coupling Ratings:
 Pleasure craft = 5,175 Nm
 Intermediate = 4,575 Nm
 Continuous = 3,050 Nm

IFC-6125-95 Coupling Weight = 2.7 kg

SECTION A-A

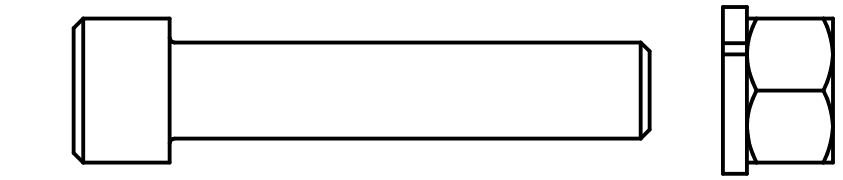

Item 2: 1/2" UNC x 2 1/2" SHCS, Nut and Spring Washer

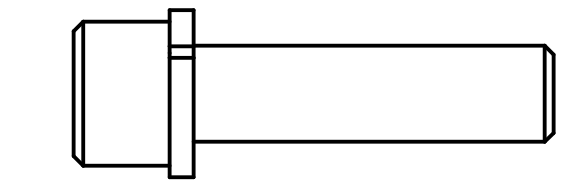

Item 3: 1/2" UNC x 2" SHCS and Spring Washer

IFC-6125-95

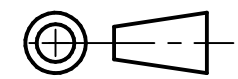

Copyright © 2020 Isoflex Technologies Pty Ltd				
TITLE		IFC6125-95 General Arrangement		
	NAME	DATE		
DRAWN	Matthew McCart	08/Jul/20		
CHECKED	-	-		
APPR	-	-		
UNLESS OTHERWISE SPECIFIED DIMENSIONS ARE IN MILLIMETERS		SIZE	DWG NO	REV
		A3	IFC6125-95 GA	B1
SPECIFICATIONS SUBJECT TO CHANGE WITHOUT NOTICE		FILE NAME: IFC6125-95_B1.dft		
SCALE: 1:1	WEIGHT:	SHEET 1 OF 1		

