

1/2" UNC SHCS - AS2465 Grade 8 Zinc Plated

Bolt Shear Capacity 'Thread' [BSC] = 52kN
 Bolt Pattern Shear Capacity [BPSC] = 12,548 Nm
 Bolt Pattern Design Torque [BPDT] = 3,137 Nm

$$BDPT = \frac{1}{4} \times BPSC$$

IFC-4900-95 Coupling Ratings:
 Pleasure craft = 2,000 Nm
 Intermediate = 1,800 Nm
 Continuous = 1,200 Nm

IFC-4900-95 Coupling Weight = 2.1 kg
 Mass Moment of Inertia I = 0.0078 kg.m²
 Average Torsional Stiffness = 147200 Nm/rad

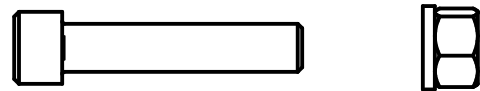

Item 2: 1/2" UNC x 2 1/2" SHCS, Nut and Spring Washer

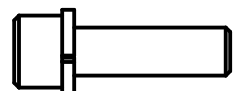

Item 3: 1/2" UNC x 1 3/4" SHCS and Spring Washer

IFC-4900-95

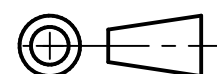

Copyright © 2022 Isoflex Technologies Pty Ltd				
TITLE		IFC4900-95 General Arrangement		
	NAME	DATE		
DRAWN	Matthew McCart	11/May/22		
CHECKED	-	-		
APPR	-	-		
UNLESS OTHERWISE SPECIFIED DIMENSIONS ARE IN MILLIMETERS		SIZE	DWG NO	REV
		A3	IFC4900-95	B2
FILE NAME: IFC4900-95 General Arrangement_B2.dft				
SPECIFICATIONS SUBJECT TO CHANGE WITHOUT NOTICE		SCALE: 1:2	WEIGHT:	SHEET 1 OF 1

